



420 Pendleton Street Alexandria, Virginia 22314

Colonial Charm with Contemporary Open Floor Plan

Spacious and bright ~ exquisite design and décor ~ numerous upgrades include hardwood floors, recessed lighting, 9 foot ceilings, crown molding and plantation shutters throughout this home.

Entertaining is a joy ~ open floor plan of living, dining and kitchen areas ~ chef's kitchen includes 42" maple cabinets, Impala Black granite countertops, GE Monogram stainless steel appliances ~ center island has under mount stainless steel bowl sink and pull out spray faucet and room for seating.

Three bedroom suites offer individual space. There is a family room with fireplace and two-car garage in the lower level and a den and roof-top terrace on the top level.

Offered At \$814,000

SUSAN CRAFT

703.216.4501

susan@susancraft.com



**109 South Pitt Street
Alexandria, Virginia 22314**

703-549-9292

fax 703-717-5827

www.mceneaney.com

Specializing in the marketing of fine residential properties.

420 Pendleton Street
Alexandria, Virginia 22314

Price: \$814,000
 Subdivision: Chatham Square
 Year Built: 2005
 Builder: Eakin Youngentob
 Model: Pendleton
 Type: Townhouse
 Style: Open Floor Plan
 Construction: Brick
 Basement: Finished
 Water: Public
 Sewer: Public
 Heat: Natural Gas
 CAC (Type): Electric
 Hot Water: Natural Gas
 Fireplace: Gas - Family Room
 Parking: 2-Car Garage
 Taxes: \$7,075 (2008)
 Elementary: Jefferson-Houston
 Middle School: G.W.
 High School: T. C. Williams
 Total Bedrooms 3
 Total Full Baths 3
 Total Half Baths 1
 Living Room (MN) 13' x 13'
 Dining Room (MN) 14' x 9'
 Kitchen (MN) 16' x 14'
 Family Room (L1) 14' x 12'
 Master BR (U1) 14' x 13'
 Bedroom 2 (U1) 13' x 10'
 Bedroom 3 (U2) 13' x 11'
 Den (U2) 14' x 12'



Upgrades:

- gas line on terrace for gas grill
- security system
- multi-media package throughout
- multi-media wired for speakers, lower level, mail level, top floor
- gourmet kitchen package
- master bath luxury shower
- master bath Whirlpool jetted tub
- hardwood staircases
- hardwood floors on upper levels
- plantation shutters
- front load washer and dryer

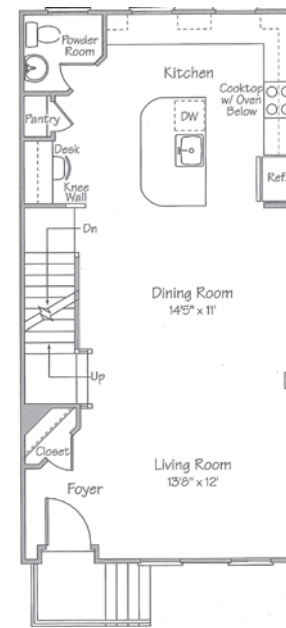

First Level

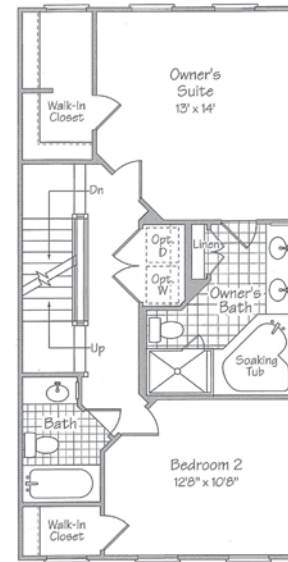

Second Level



Third Level

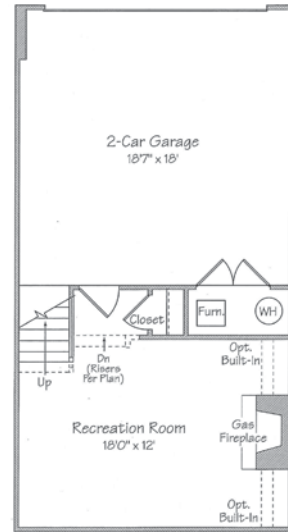

Lower Level



SUSAN CRAFT

703.216.4501

susan@susancraft.com



All information is deemed accurate, but as it is provided by third parties, it is not guaranteed.



www.mceneaney.com